

Plan de amplasament si delimitare a imobilului  
Scara 1: 2000

Cartea funciara nr.	Suprafata masurata	Adresa imobilului
	6140	Loc. Baia Mare, str. Ariniului - intravilan extravilan
Nr. cadastral	U.A.T.	BALAMARE

ANEXA NR. 1 LA HCL NR 12024

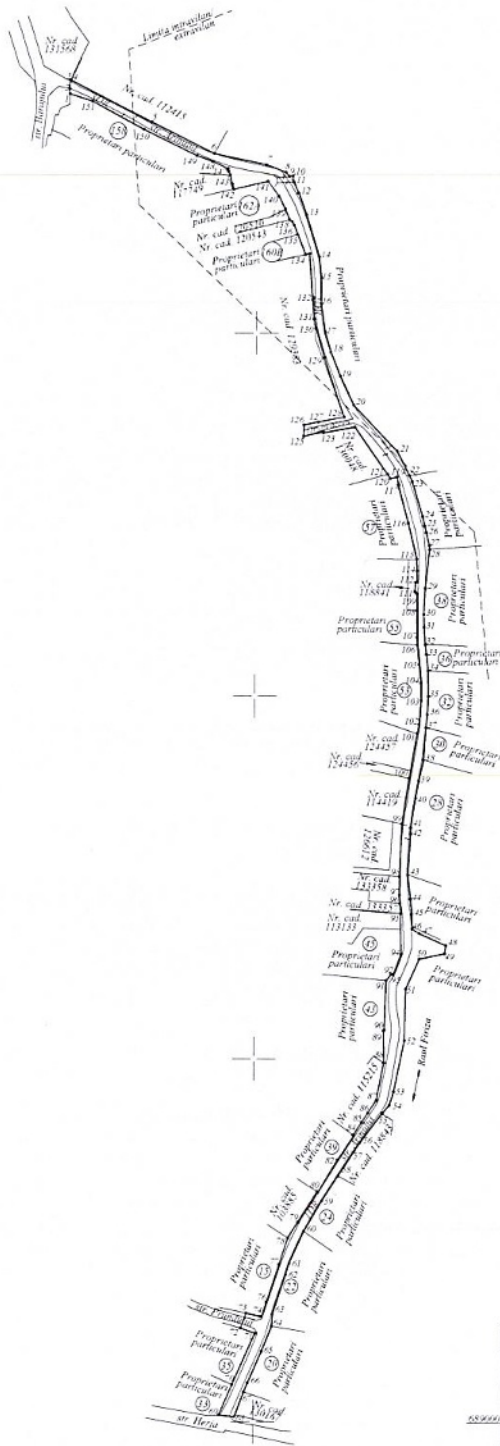

Nr. Pt.	Longimi laterale (m)	Nr. Pt.	Longimi laterale (m)
1	2,793	58	10,878
2	4,672	59	19,583
3	0,377	60	0,443
4	50,070	61	20,888
5	38,500	62	16,287
6	29,263	63	9,479
7	11,547	64	8,424
8	3,043	65	6,521
9	2,038	66	8,456
10	3,331	67	21,062
11	6,629	68	17,759
12	12,578	69	9,648
13	24,371	70	27,064
14	11,390	71	4,440
15	14,621	72	1,222
16	15,737	73	11,753
17	11,321	74	22,682
18	14,300	75	3,484
19	17,697	76	4,737
20	35,086	77	10,059
21	14,937	78	29,268
22	3,706	79	25,411
23	20,070	80	25,028
24	5,140	81	5,690
25	4,029	82	13,287
26	7,143	83	9,859
27	2,191	84	10,381
28	21,574	85	10,812
29	14,382	86	4,126
30	7,076	87	14,829
31	9,646	88	8,936
32	5,497	89	1,227
33	9,107	90	0,761
34	13,998	91	5,028
35	10,190	92	0,939
36	7,330	93	6,339
37	17,889	94	6,417
38	11,962	95	20,416
39	9,433	96	21,704
40	16,676	97	0,261
41	3,262	98	4,228
42	22,651	99	3,785
43	13,455	100	2,810
44	8,349	101	31,681
45	7,931	102	17,666
46	4,895	103	0,919
47	15,061	104	11,492
48	4,549	105	6,190
49	14,086	106	8,121
50	18,238	107	14,653
51	28,461	108	34,554
52	28,898	109	16,847
53	7,907	110	5,163
54	5,850	111	10,623
55	20,461	112	25,509
56	5,797	113	2,194
57	16,121	114	11,880
58	16,475	115	5,449
59	19,525	116	2,091
60	19,315	117	1,998
61	6,495	118	6,124
62	22,935	119	8,991
63	6,698	120	10,044
64	14,941	121	19,323
65	18,939	122	2,976
66	5,421	123	5,130
67	14,637	124	2,180
68	8,605	125	1,269
69	18,163	126	0,723
70	30,927	127	9,309
71	8,333	128	9,122
72	8,999	129	22,576
73	7,883	130	22,244
74	0,833	131	13,283
75	8,594		
76	21,787		
77	15,276		

A. Date referitoare la teren				
Nr. parcela	Categoria de folosinta	Suprafata (mp)	Intravilan Extravilan	Mentii
1	DR	4306	Intravilan	Teren partial imprejmuit
2		1623	Extravilan	
3		211	Intravilan	
Total		6140		

B. Date referitoare la constructii				
Cod	Destinatia	Suprafata construita la sol (mp)	Mentii	
-	-	-	-	
Total		-	-	

Suprafata totala masurata a imobilului = 6140 mp  
Suprafata din act = 6140 mp



Encucinat: TOPOARIS S.R.L. CUI 16606217  
seria BO-B-J Nr. 2011/2021 Clasa III  
RUGA VASILE RALDI  
seria ME-Sr. 23, categoria B C  
Confirm echitarea marcarilor la teren, corectitudinea  
anexelor documentare cadastrale si corespundenta acestora  
cu realitatea din teren

Inspector  
Continut introducerea imobilului in baza de date integrata si atribuirea  
numarului cadastral  
Semnatura si parafa  
Data:

Data: Iunie 2024

Stampila BCP